

- NOTES:**
- BATHYMETRIC SURVEY COMPLETED ON AUGUST 24, 2021. SOUNDINGS ARE GEODETIC AND REFERENCED TO NSHPN 205601. SOUNDINGS GENERATED FROM MULTIBEAM OBSERVATIONS. DEPTH CONTOURS SHOWN IN METRES (CGVD2013).
 - TOPOGRAPHIC LAND SURVEY: BEARINGS ARE GRID DERIVED FROM GNSS OBSERVATION TO NSHPN 205601, REFERENCED TO THE NOVA SCOTIA 3° MODIFIED TRANSVERSE MERCATOR PROJECTION, ZONE 5, CENTRAL MERIDIAN 64°30' W; BASED ON THE HORIZONTAL REFERENCE FRAME NAD83 (CSRS), EPOCH 2010.0. ELEVATIONS ARE REFERENCED TO NSHPN 205601, HAVING AN ELEVATION OF 22.048 METRES (CGVD2013).
 - LOCATION OF EXISTING UNDERGROUND INFRASTRUCTURE IS BASED ON BEST AVAILABLE INFORMATION, INCLUDING RECORD INFORMATION FROM HALIFAX REGIONAL WATER COMMISSION, AND IS APPROXIMATE ONLY.
 - PROPERTY LINES FOR PARCELS OTHER THAN PID: 00114132 ARE BASED ON PROVINCIAL MAPPING INFORMATION AND ARE SUBJECT TO LEGAL SURVEY.
 - PROPERTY BOUNDARY FOR PID: 00114132 BASED ON SURVEY PLAN PREPARED BY DESIGNPOINT ENGINEERING & SURVEYING LTD., DATED DECEMBER 14, 2021.

**ISSUED FOR PERMIT
NOT FOR CONSTRUCTION**

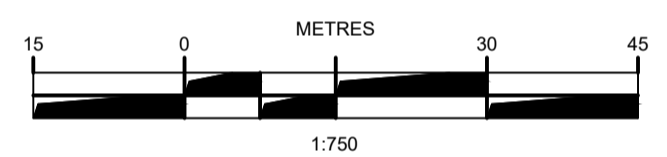

ISSUE	DATE	DESCRIPTION	CONSULTANT
2	MAR. 23, 2022	ISSUED FOR PERMITTING	
1	NOV. 25, 2021	ISSUED FOR REVIEW	

DESIGNPOINT
engineering • surveying • solutions
902.832.5597 designpoint.ca

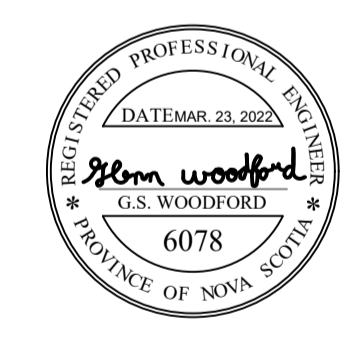

CLIENT
4197847 NOVA SCOTIA LIMITED

PROJECT DESCRIPTION
DARTMOUTH COVE WATERFRONT ACCESS
DARTMOUTH, NOVA SCOTIA

SHEET DESCRIPTION
EXISTING SITE CONDITIONS

Drawn K. HINES	Engineer G. WOODFORD	Project No. 21-275	Drawing No. C-01
Scale 1:750	Filename 21-275_C.dwg	1 of 2	

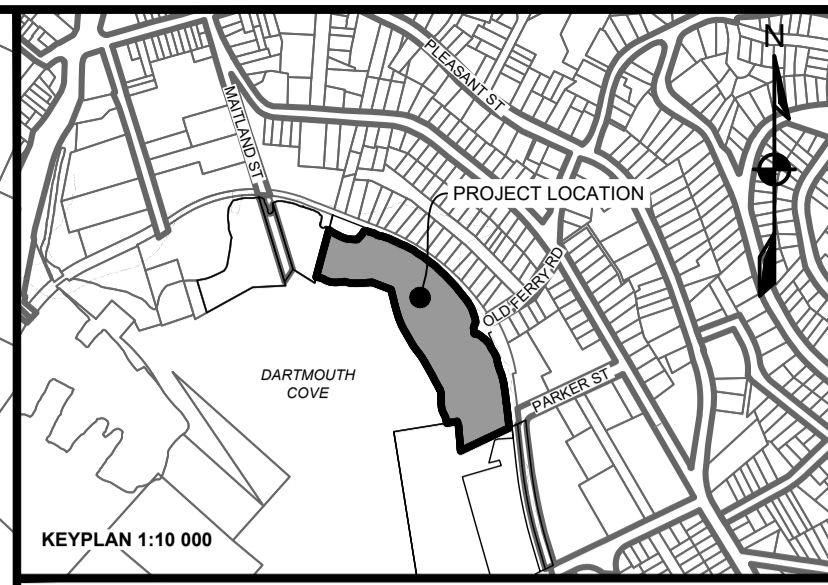
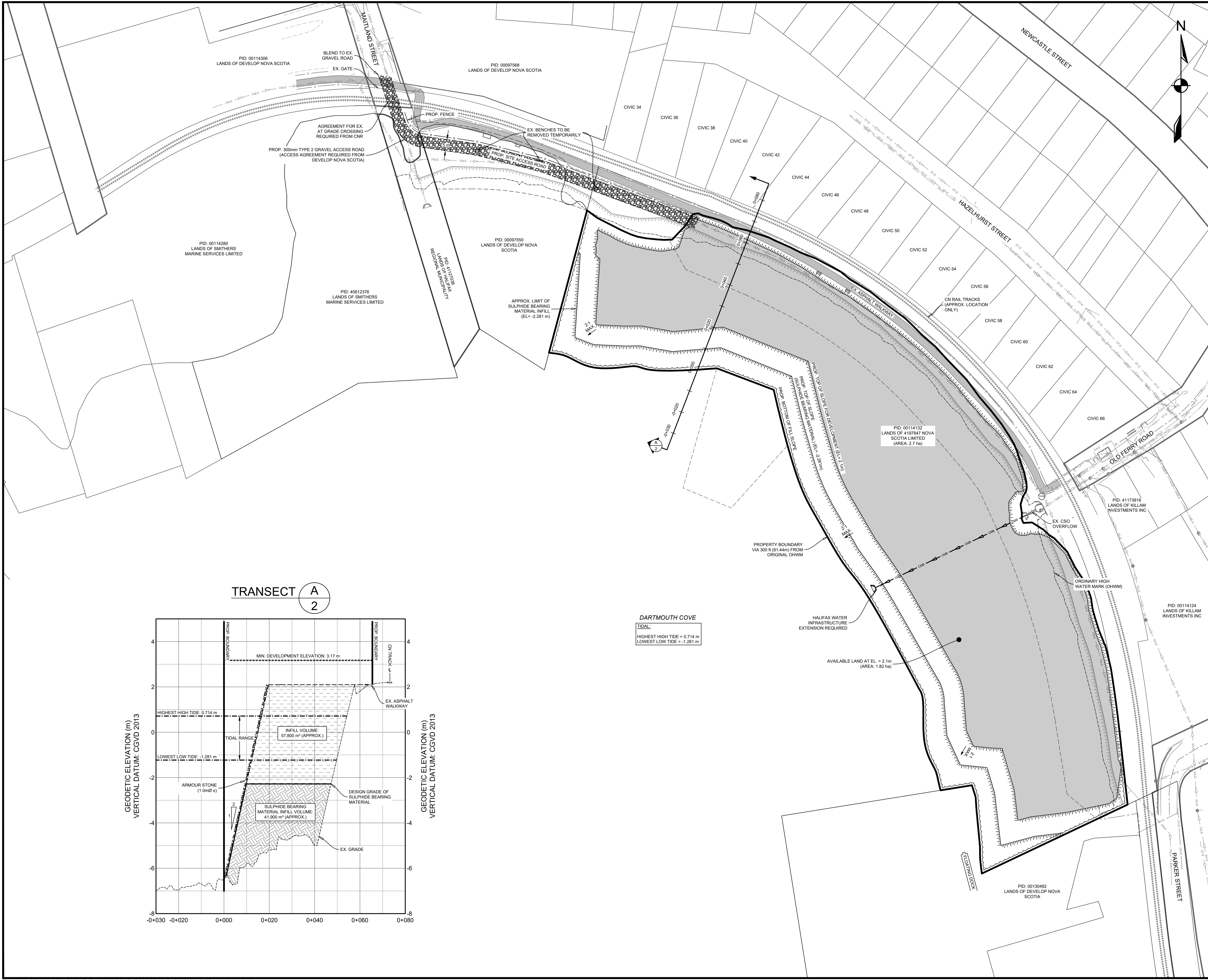

LEGEND

EXISTING	PROPOSED
10	MAJOR CONTOUR
10	MINOR CONTOUR
10	MAJOR CONTOUR (SEA FLOOR)
10	MINOR CONTOUR (SEA FLOOR)
---	EASEMENT
---	RIGHT OF WAY
---	LOT LINE
ST-E	STORM LINE
WA-E	WATER PIPE
SA-E	SANITARY PIPE
CB-E	COMBINED PIPE
FM-E	COMBINED FORCEMAIN
---	TOP OF SLOPE
---	BOTTOM OF SLOPE
X	FENCELINE
---	PRECAST HEADWALL
---	CATCHBASIN

ISSUED FOR PERMIT
NOT FOR CONSTRUCTION

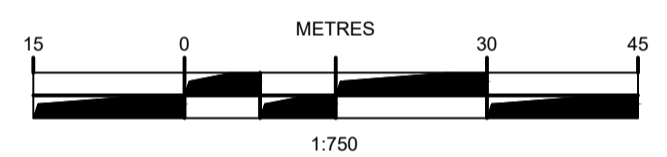

ISSUE	DATE	DESCRIPTION
2	MAR. 23, 2022	ISSUED FOR PERMITTING
1	NOV. 25, 2021	ISSUED FOR REVIEW

DESIGNPOINT
engineering • surveying • solutions
902.832.5597 designpoint.ca

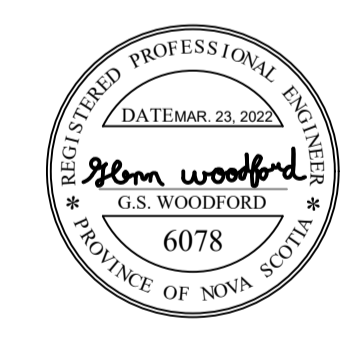

CLIENT
4197847 NOVA SCOTIA LIMITED

PROJECT DESCRIPTION
DARTMOUTH COVE WATERFRONT ACCESS
DARTMOUTH, NOVA SCOTIA

SHEET DESCRIPTION
CONCEPT PLAN

Drawn K. HINES	Engineer G. WOODFORD	Project No. 21-275	Drawing No. C-02
Scale 1:750 H, 1:75 V	Filename 21-275_C.dwg		2 of 2

P:\2022\21-275 ARCP - Marine Infill\01 - Drawings\Eng Design\21-275_C.dwg, Plot Date: 2022-Mar-23, Plot Size: ISO FULL BLEED A1 (841.00 X 594.00 MM)