

- KEYPLAN 1:10 000
- NOTES:
- BATHYMETRIC SURVEY COMPLETED ON AUGUST 24, 2021. SOUNDINGS ARE GEODETIC AND REFERENCED TO NSHPN 205601. SOUNDINGS GENERATED FROM MULTIBEAM OBSERVATIONS. DEPTH CONTOURS SHOWN IN METRES (CGVD2013).
 - TOPOGRAPHIC LAND SURVEY: BEARINGS ARE GRID DERIVED FROM GNSS OBSERVATION TO NSHPN 205601, REFERENCED TO THE NOVA SCOTIA 3° MODIFIED TRANSVERSE MERCATOR PROJECTION, ZONE 6, CENTRAL MERIDIAN 64°30' W; BASED ON THE HORIZONTAL REFERENCE FRAME NAD83 (CSRS), EPOCH 2010.0. ELEVATIONS ARE REFERENCED TO NSHPN 205601, HAVING AN ELEVATION OF 22.048 METRES (CGVD2013).
 - LOCATION OF EXISTING UNDERGROUND INFRASTRUCTURE IS BASED ON BEST AVAILABLE INFORMATION, INCLUDING RECORD INFORMATION FROM HALIFAX REGIONAL WATER COMMISSION, AND IS APPROXIMATE ONLY.
 - PROPERTY LINES FOR PARCELS OTHER THAN PID: 00114132 ARE BASED ON PROVINCIAL MAPPING INFORMATION AND ARE SUBJECT TO LEGAL SURVEY.
 - PROPERTY BOUNDARY FOR PID: 00114132 BASED ON SURVEY PLAN PREPARED BY DESIGNPOINT ENGINEERING & SURVEYING LTD., DATED DECEMBER 14, 2021.

DRAFT
NOT FOR
CONSTRUCTION

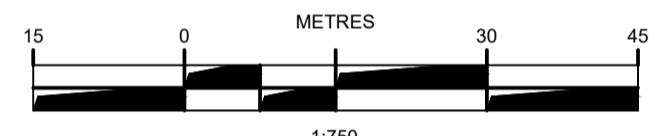

ISSUE	DATE	DESCRIPTION
7	NOV. 08, 2023	ADDED QUARRY ROCK & ENVIRONMENTAL OFFSETTING PLAN
6	JUN. 12, 2023	REVISED AS PER CLIENT COMMENTS
5	MAY 30, 2023	REISSUED FOR DFO PERMIT
4	OCT. 17, 2022	ISSUED TO CN FOR REVIEW
3	JUN. 22, 2022	REVISED AS PER DFO COMMENTS
2	MAR. 23, 2022	ISSUED FOR PERMITTING
1	NOV. 25, 2021	ISSUED FOR REVIEW

CONSULTANT

DESIGNPOINT
engineering • surveying • solutions

902.832.5597 designpoint.ca



CLIENT

4197847 NOVA SCOTIA LIMITED

PROJECT DESCRIPTION

DARTMOUTH COVE WATERFRONT ACCESS
DARTMOUTH, NOVA SCOTIA

SHEET DESCRIPTION

EXISTING SITE CONDITIONS

Drawn K. HINES	Engineer G. WOODFORD	Project No. 21-275	Drawing No. C-01
Scale 1:750	Filename 21-275_C.dwg	1 of 4	

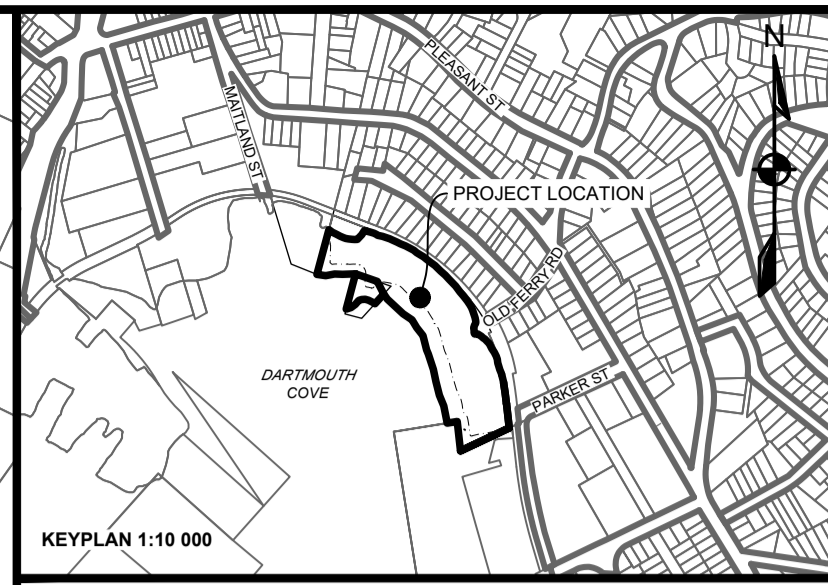
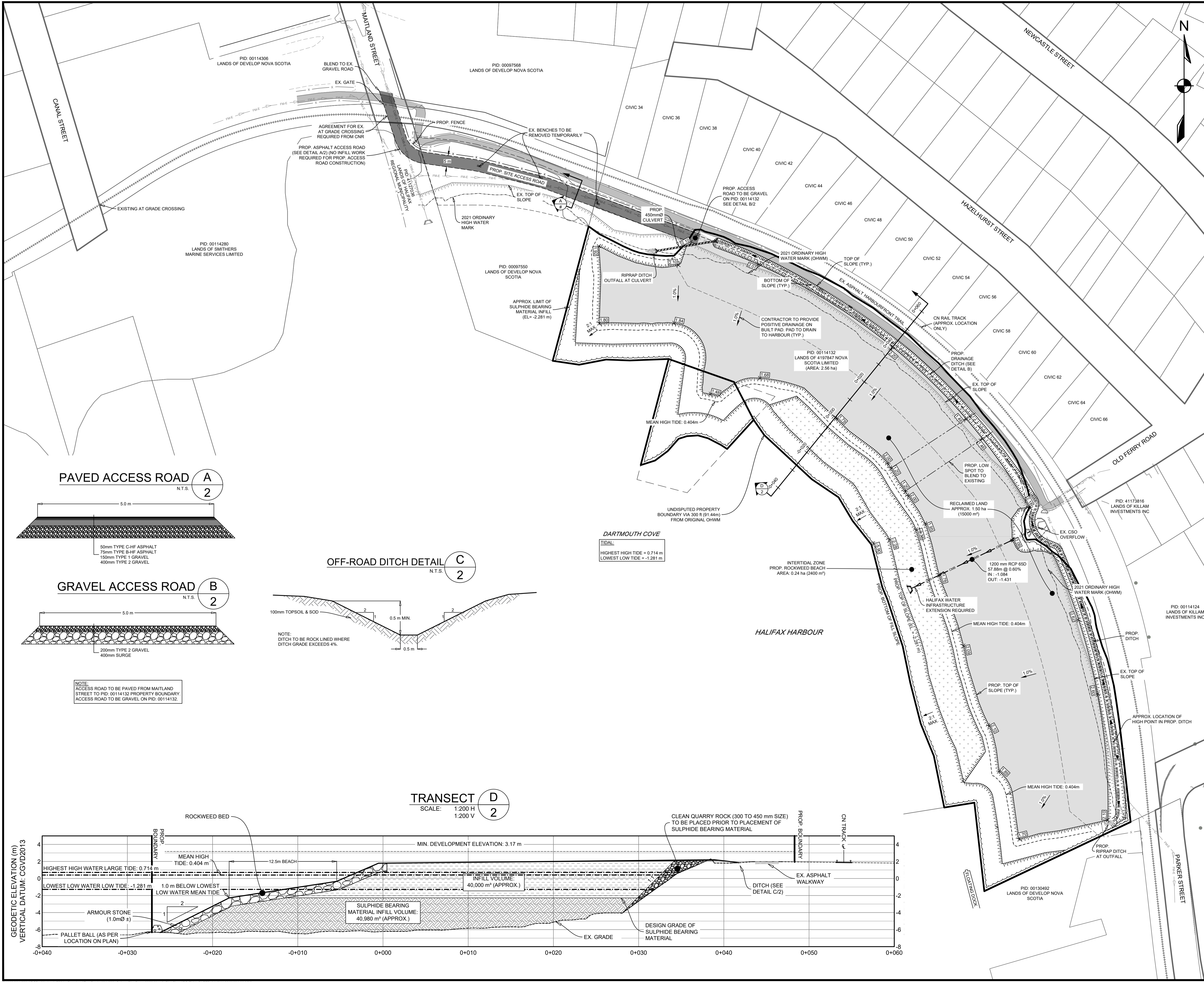

LEGEND

EXISTING	PROPOSED
-10 -	MAJOR CONTOUR
-10 -	MINOR CONTOUR
-10 -	MAJOR CONTOUR (SEA FLOOR)
-10 -	MINOR CONTOUR (SEA FLOOR)
- - -	EASEMENT
—	RIGHT OF WAY
—	LOT LINE
—	COMBINED PIPE
—	COMBINED FORCEMAIN
—	TOP OF SLOPE
—	BOTTOM OF SLOPE
-x-x-	FENCELINE
—	PRECAST HEADWALL
—	CULVERT

NOTE:
 PROPOSED WORK IS SUBJECT TO APPROVAL FROM ALL REGULATORY BODIES. THIS INCLUDES BUT IS NOT LIMITED TO HALIFAX REGIONAL WATER COMMISSION, NOVA SCOTIA ENVIRONMENT, DEPARTMENT OF FISHERIES AND OCEANS, TRANSPORT CANADA, ETC. CONTRACTOR TO ENSURE ALL REQUIRED PERMITS FROM REGULATORY BODIES ARE ACQUIRED PRIOR TO CONSTRUCTION.

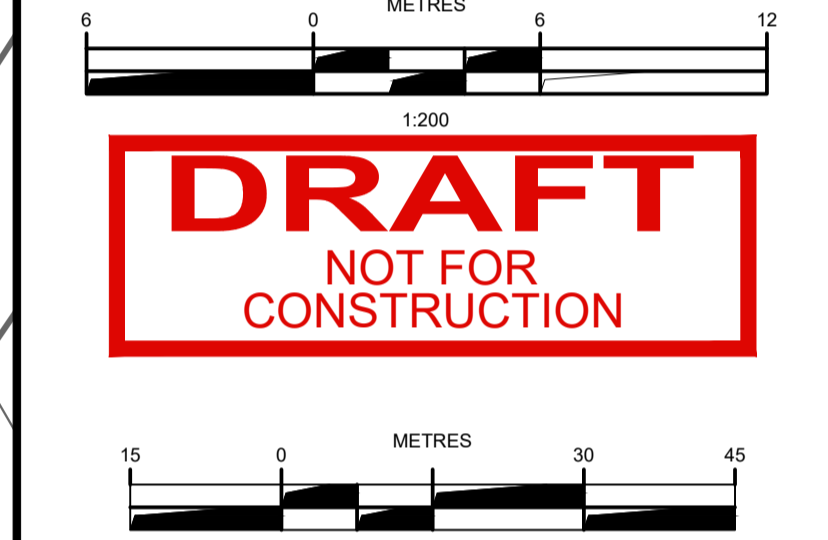

ISSUE	DATE	DESCRIPTION	CONSULTANT
7	NOV. 08, 2023	ADDED QUARRY ROCK & ENVIRONMENTAL OFFSETTING PLAN	
6	JUN. 12, 2023	REVISED AS PER CLIENT COMMENTS	
5	MAY. 30, 2023	ISSUED FOR DFO PERMIT	
4	OCT. 17, 2022	ISSUED TO CN FOR REVIEW	
3	JUN. 22, 2022	REVISED AS PER DFO COMMENTS	
2	MAR. 23, 2022	ISSUED FOR PERMITTING	
1	NOV. 25, 2021	ISSUED FOR REVIEW	

DESIGNPOINT
 engineering • surveying • solutions
 902.832.5597 designpoint.ca

CLIENT
4197847 NOVA SCOTIA LIMITED

PROJECT DESCRIPTION
DARTMOUTH COVE WATERFRONT ACCESS
 DARTMOUTH, NOVA SCOTIA
 SHEET DESCRIPTION

SITE PLAN

Drawn K.HINES	Engineer G.WOODFORD	Project No. 21-275	Drawing No. C-02
Scale 1:750	Filename 21-275_C.dwg		2 of 4

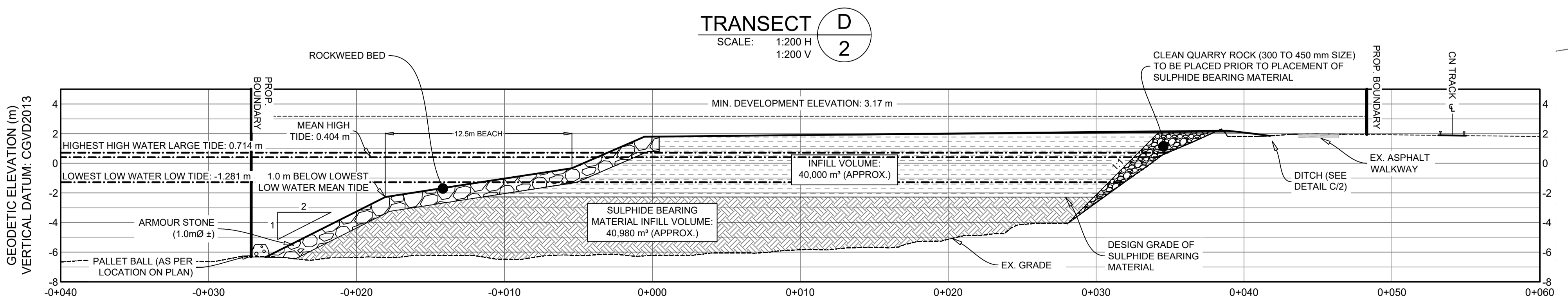
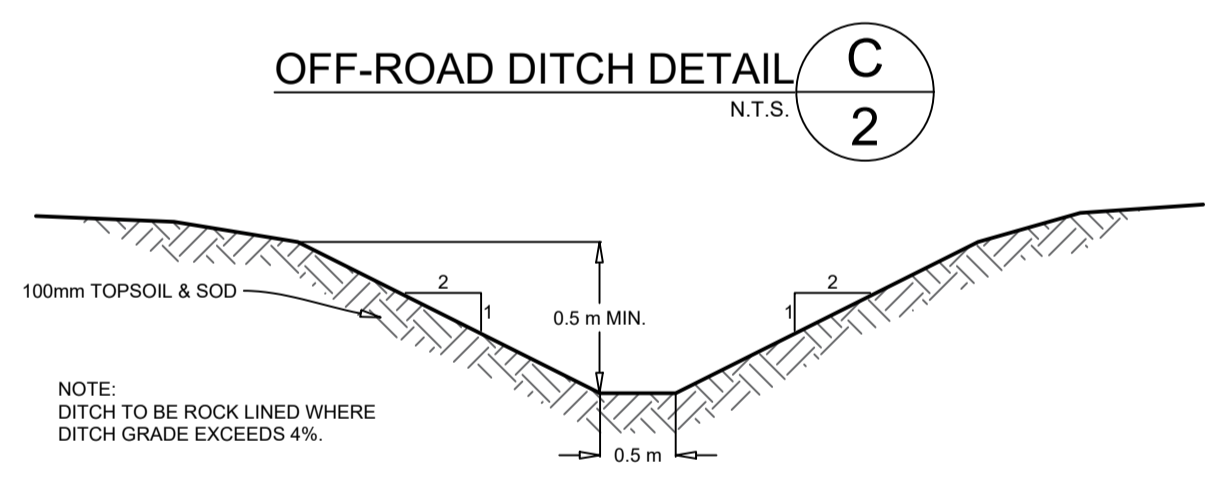
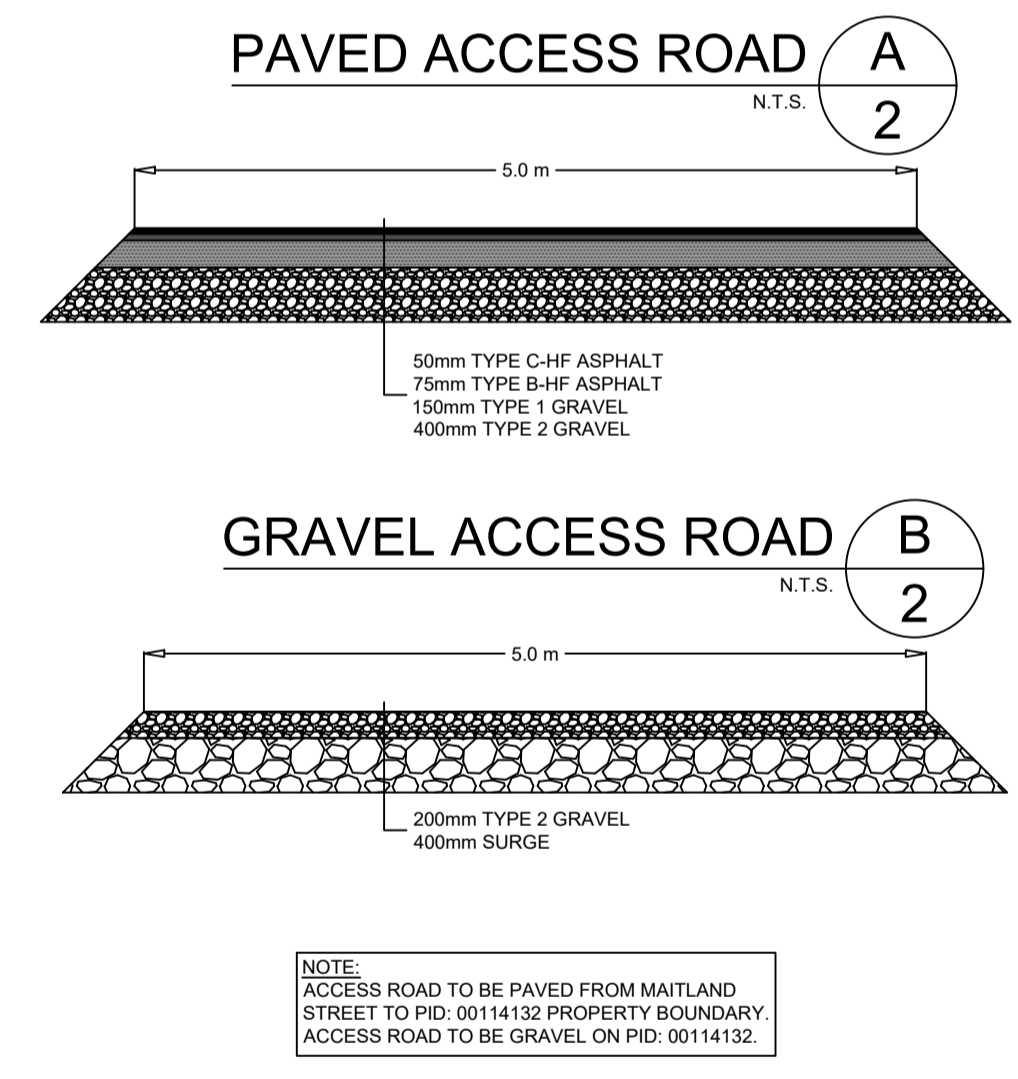

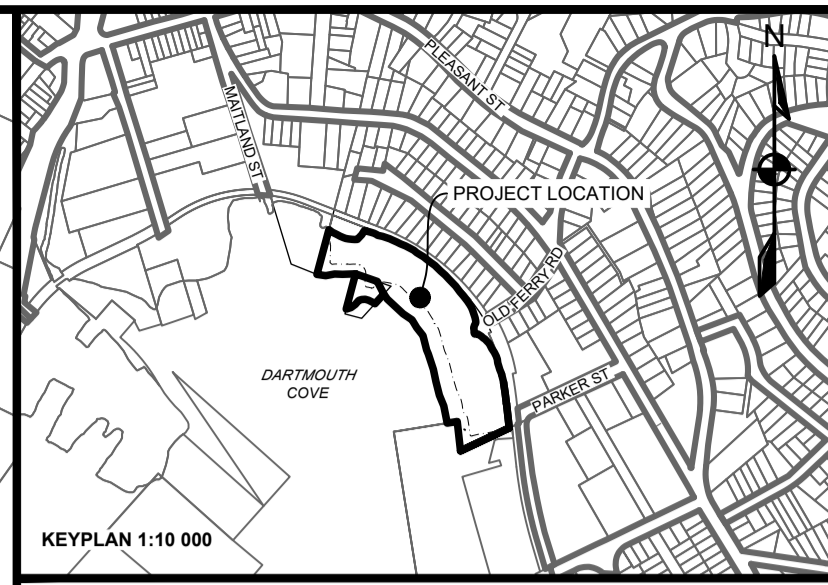
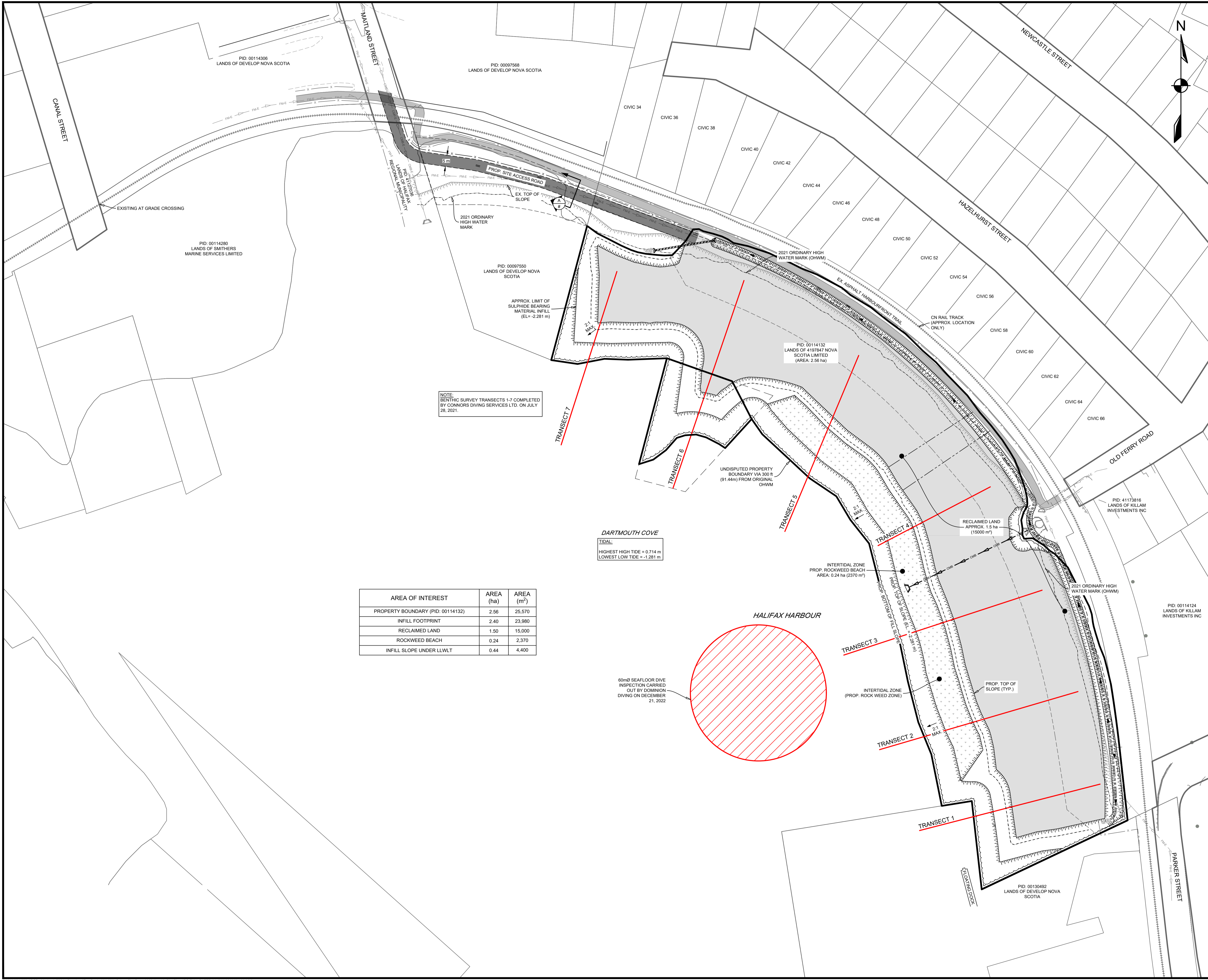

LEGEND

EXISTING	PROPOSED
— 10 —	MAJOR CONTOUR — 10 —
— 10 —	MINOR CONTOUR — 10 —
— 10 —	MAJOR CONTOUR (SEA FLOOR)
— 10 —	MINOR CONTOUR (SEA FLOOR)
---	EASEMENT
---	RIGHT OF WAY
---	LOT LINE
— CMB —	COMBINED PIPE
— FM —	COMBINED FORCEMAIN
---	TOP OF SLOPE
---	BOTTOM OF SLOPE
---	FENCELINE
---	PRECAST HEADWALL
---	CULVERT

NOTE:
 PROPOSED WORK IS SUBJECT TO APPROVAL FROM ALL REGULATORY BODIES. THIS INCLUDES BUT IS NOT LIMITED TO HALIFAX REGIONAL WATER COMMISSION, NOVA SCOTIA ENVIRONMENT, DEPARTMENT OF FISHERIES AND OCEANS, TRANSPORT CANADA, ETC. CONTRACTOR TO ENSURE ALL REQUIRED PERMITS FROM REGULATORY BODIES ARE ACQUIRED PRIOR TO CONSTRUCTION.

DRAFT
 NOT FOR CONSTRUCTION

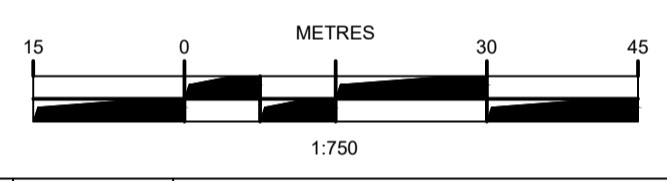

ISSUE	DATE	DESCRIPTION
7	NOV. 08, 2023	ADDED QUARRY ROCK & ENVIRONMENTAL OFFSETTING PLAN
6	JUN. 12, 2023	REVISED AS PER CLIENT COMMENTS
5	MAY. 30, 2023	REISSUED FOR DFO PERMIT
4	OCT. 17, 2022	ISSUED TO CN FOR REVIEW
3	JUN. 22, 2022	REVISED AS PER DFO COMMENTS
2	MAR. 23, 2022	ISSUED FOR PERMITTING
1	NOV. 25, 2021	ISSUED FOR REVIEW

AREA OF INTEREST	AREA (ha)	AREA (m²)
PROPERTY BOUNDARY (PID: 00114132)	2.56	25,570
INFILL FOOTPRINT	2.40	23,980
RECLAIMED LAND	1.50	15,000
ROCKWEED BEACH	0.24	2,370
INFILL SLOPE UNDER LLWLT	0.44	4,400

DARTMOUTH COVE
 TIDAL:
 HIGHEST HIGH TIDE = 0.714 m
 LOWEST LOW TIDE = -1.281 m

DESIGNPOINT
 engineering • surveying • solutions

902.832.5597 designpoint.ca



CLIENT

4197847 NOVA SCOTIA LIMITED

PROJECT DESCRIPTION

DARTMOUTH COVE WATERFRONT ACCESS

DRATMOUTH, NOVA SCOTIA
 SHEET DESCRIPTION

DIVE INSPECTION

Drawn K.HINES	Engineer G.WOODFORD	Project No. 21-275	Drawing No. C-03
Scale 1:750	Filename 21-275_C.dwg		3 of 4

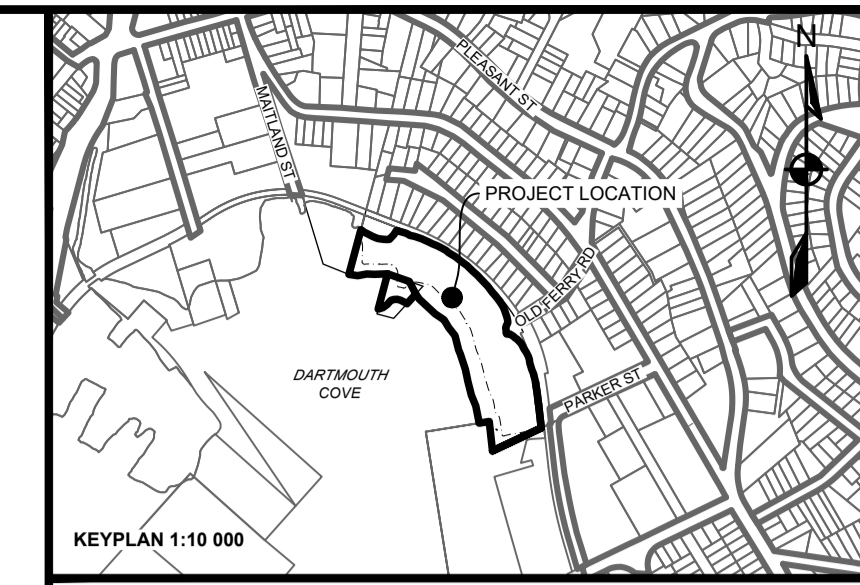

LEGEND

EXISTING	PROPOSED
-10-	MAJOR CONTOUR
-10-	MINOR CONTOUR
-10-	MAJOR CONTOUR (SEA FLOOR)
-10-	MINOR CONTOUR (SEA FLOOR)
- - - - -	EASEMENT
=====	RIGHT OF WAY
=====	LOT LINE
-----	COMBINED PIPE
-----	COMBINED FORCEMAIN
-----	TOP OF SLOPE
-----	BOTTOM OF SLOPE
-----	FENCELINE

EXISTING	PROPOSED
=====	PRECAST HEADWALL
=====	CULVERT

NOTE:
PROPOSED WORK IS SUBJECT TO APPROVAL FROM ALL REGULATORY BODIES. THIS INCLUDES BUT IS NOT LIMITED TO HALIFAX REGIONAL WATER COMMISSION, NOVA SCOTIA ENVIRONMENT, DEPARTMENT OF FISHERIES AND OCEANS, TRANSPORT CANADA, ETC. CONTRACTOR TO ENSURE ALL REQUIRED PERMITS FROM REGULATORY BODIES ARE ACQUIRED PRIOR TO CONSTRUCTION.



DRAFT
NOT FOR CONSTRUCTION

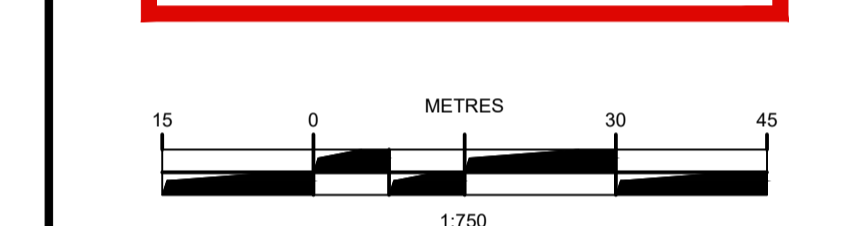

ISSUE	DATE	DESCRIPTION
1	NOV. 08, 2023	ISSUED FOR REVIEW

DESIGNPOINT
engineering • surveying • solutions
902.832.5597 designpoint.ca

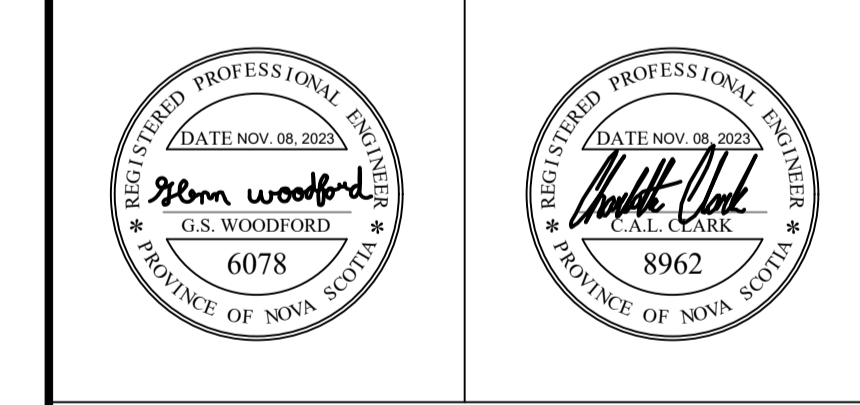

CLIENT
4197847 NOVA SCOTIA LIMITED

PROJECT DESCRIPTION
DARTMOUTH COVE WATERFRONT ACCESS
DARTMOUTH, NOVA SCOTIA

SHEET DESCRIPTION
ENVIRONMENTAL OFFSETTING PLAN

Drawn	Engineer	Project No.	Drawing No.
S. HANNAM	G. WOODFORD	21-275	C-04
Scale	Filename		
1:750	21-275_C.dwg		4 of 4

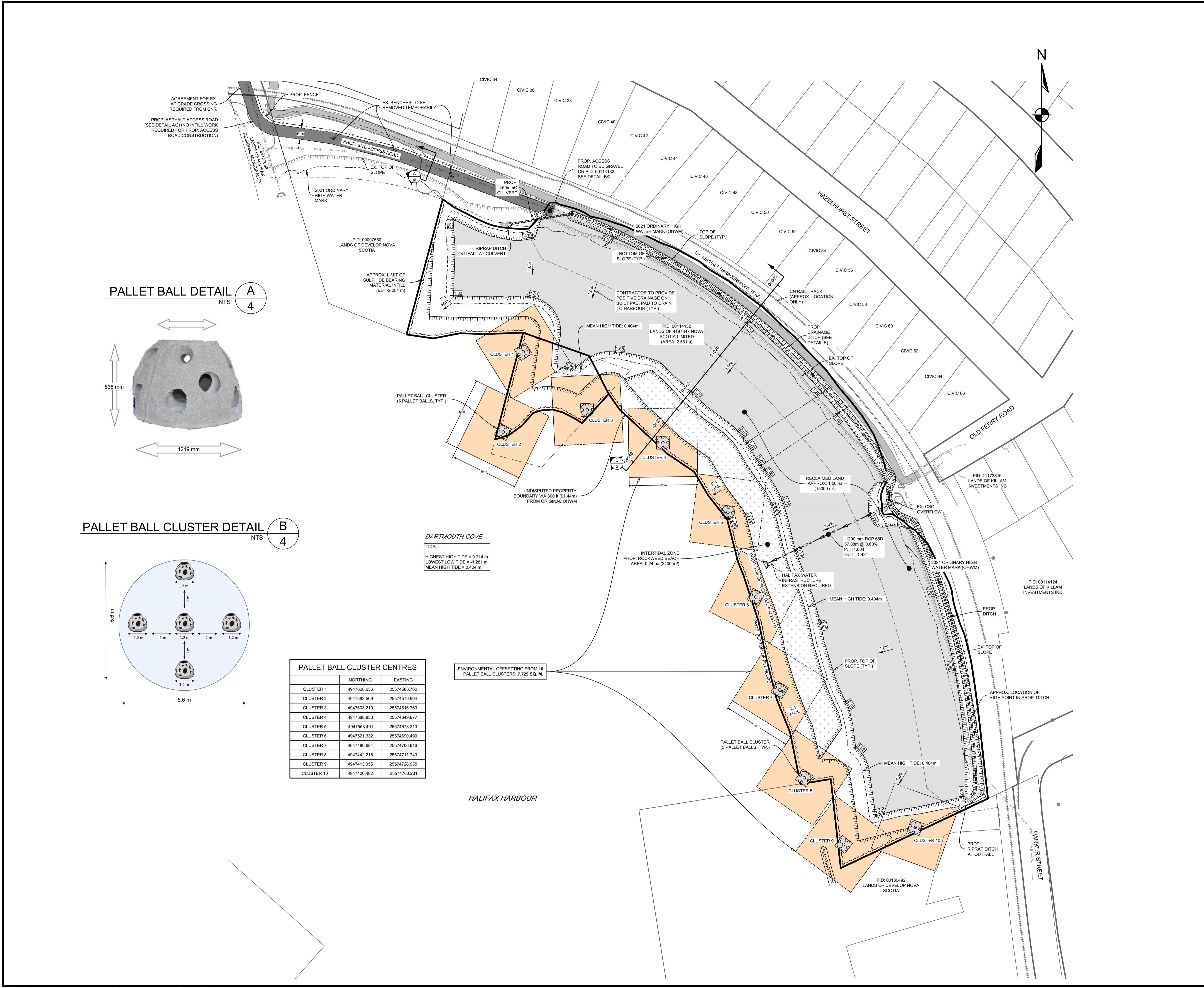

PALLET BALL DETAIL
NTS 4



PALLET BALL CLUSTER DETAIL
NTS 4

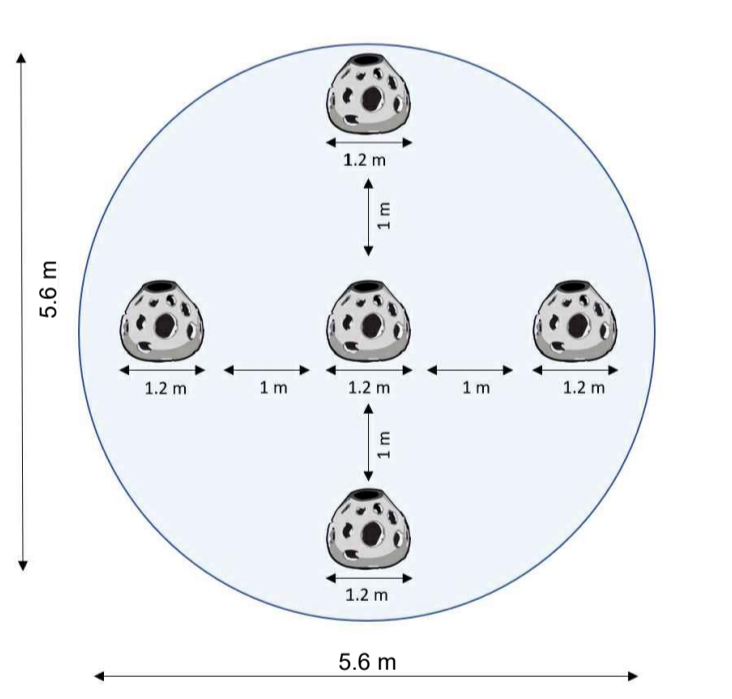

PALLET BALL CLUSTER CENTRES	NORTHING	EASTING
CLUSTER 1	4947628.636	25574588.762
CLUSTER 2	4947593.509	25574579.964
CLUSTER 3	4947603.219	25574616.763
CLUSTER 4	4947588.850	25574649.877
CLUSTER 5	4947558.401	25574678.313
CLUSTER 6	4947521.332	25574690.499
CLUSTER 7	4947480.684	25574700.916
CLUSTER 8	4947442.218	25574711.743
CLUSTER 9	4947413.055	25574728.935
CLUSTER 10	4947420.482	25574760.231

ENVIRONMENTAL OFFSETTING FROM 10 PALLET BALL CLUSTERS: **7,729 SQ. M.**